

Specifications

	P501X	P451X	P451W	P401W	PE501X
LCD Panel	1024 x 768 pixels		1280 x 800 pixels		1024 x 768 pixels
Resolution <sup>1</sup>	1024 x 768 pixels		1280 x 800 pixels		1024 x 768 pixels
Lens	Manual Focus / F=1.7 to 2.2, f=17.4 to 29.0 mm Throw ratio 1.3 to 2.2				
Lamp <sup>2</sup> (Eco Mode On / Eco Mode Off)	163 W / 270 W	163 W / 240 W	163 W / 270 W	163 W / 240 W	163 W / 270 W
Lens shift	0 ~ +0.5V	0 ~ +0.5V	0 ~ +0.6V	0 ~ +0.6V	0 ~ +0.5V
Lamp Life <sup>2</sup> (Eco Mode On / Eco Mode Off)	6000 H / 3500 H	6000 H / 4000 H	6000 H / 3500 H	6000 H / 4000 H	6000 H / 3500 H
Image Size	25 to 300 inches				
Colour reproduction	10 bit signal processing, 1.07 billion colours (viewer, Network, 16.7 million colours)				
Light Output <sup>3</sup> - <sup>4</sup>	Eco Mode Off Eco Mode On	5000 ANSI lumens Approx.60 %	4500 ANSI lumens Approx.67 %	4500 ANSI lumens Approx.60 %	4000 ANSI lumens Approx.67 %
Contrast Ratio (white / black) <sup>4</sup>	4000 : 1 with iris				
Maximum Resolution	WUXGA (1920 x 1200) with Advanced AccuBlend				
Scan Rate	Horizontal: 15 to 100 KHz (RGB: 24 kHz or over), Vertical: 50 to 120 Hz				
Keystone Correction	Horizontal/ Vertical : Approx. ±30 degree				
Input Terminals	Computer	1 x Mini D-Sub 15 pin 1 x Stereo mini Jack			
	Video	1 x RCA			
	Audio	2 x RCA			
	S-Video	1 x Mini Din 4 pin			
	Audio	2 x RCA (shared with Video)			
	HDMI	2 x HDMI			
	Audio	HDMI or Stereo Mini Jack (Computer Audio IN)			
	Mic	1 x Mini Jack			
Output Terminals	Audio	1 x Mini D-Sub 15 pin 1 x Stereo Mini Jack			
Wired LAN port	1 x RJ-45 (10BASE-T / 100BASE-TX)				—
Wireless LAN port	Yes				—
Control Terminals	1 x D-sub 9 pin				
USB Port (for USB Display)	1 x Type A, 1 x Type B				1 x Type B
Built-in speaker	16 W monaural				
Environment	Operation Temperature	5°C-40°C ((ECO MODE) is set automatically to [ON] at 35°C to 40°C), 20% to 80% Humidity (Non-Condensing)			
	Storage Temperature	-10°C-50°C, 20 %-80 % Humidity (Non-Condensing)			
Power requirement	100 to 240 V AC, 50 Hz / 60 Hz				
Input Current (100 - 130 V / 200 - 240 V)	4.2 A to 1.7 A	3.9 A to 1.6 A	4.2 A to 1.7 A	3.9 A to 1.6 A	4.2 A to 1.7 A
Power Consumption (100 - 130 V / 200 - 240 V)	Eco Mode Off Eco Mode On	374 W / 357 W	341 W / 325 W	374 W / 357 W	341 W / 325 W
	Standby Mode(power saving)	260 W / 248 W			253 W / 241 W
Calorific Value (100 - 130 V / 200 - 240 V)	1276 BTU / 1218 BTU	1164 BTU / 1109 BTU	1276 BTU / 1218 BTU	1164 BTU / 1109 BTU	1252 BTU / 1194 BTU
Net Dimensions (W x H x D)	398 x 115 x 282 mm				—
Weight	4.1 kg				4.0 kg
Packing Dimensions (W x H x D)	478 x 390 x 233 mm				—
Packing Weight	5.5 kg				5.4 kg
Accessories	Power cord, Remote control, Batteries, Signal cable, CD-ROM (User's manual, Utility software), Security sticker				
Regulations	For United States	UL Approved (UL 60950-1), Meets FCC Class B Requirements			
	For Canada	C-UL Approved (CSA 60950-1), Meets DOC Canada Class B Requirements			
	For Europe	Meets low voltage directive (EN60950-1, TÜV GS approved), (Meets EN55022 ClassB, EN55024, EN61000-3-2, EN61000-3-3)			
	For Asia / Oceania	IEC60950-1, Meets AS/NZS CISPR.22 Class B			
	For Korea	KC (safety : K60950-1, EMC : K00022, K00024)			
	For China	GB4943, GB9254, GB17625.1			
	For Russia	Gost R 60950-1			

<sup>1</sup>: Effective pixels are more than 99.99%.  
<sup>2</sup>: Lamp life is defined as the average time span for the brightness of the lamp to be reduced by half, it does not refer to the warranty period for the lamp.  
<sup>3</sup>: This is the light output value (ANSI lumens) when the [PRESET] mode is set to [HIGH-BRIGHT]. If any other mode is selected as the [PRESET] mode, the light output value may drop slightly.  
<sup>4</sup>: Compliance with ISO21118-2005

All specifications are subject to change without notice.

● **Throw Distance and Screen Size**

(Image is WXGA)

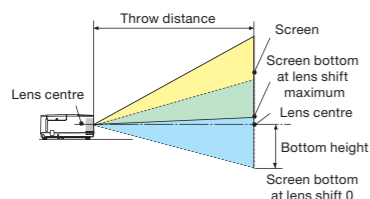

**P501X/P451X/PE501X (Aspect ratio 4:3)**

Screen size (m)	Throw distance (m)		Bottom height (cm)	
	Wide	Tele	At Lens Shift 0	At Lens Shift Maximum
30 (0.81x 0.46)	0.78	1.33	-22.9	0
40 (0.81x 0.91)	1.06	1.79	-30.5	0
60 (1.22x 0.91)	1.62	2.71	-45.7	0
80 (1.63x 1.22)	2.17	3.64	-61.0	0
100 (2.03x 1.52)	2.73	4.56	-76.2	0
120 (2.44x 1.83)	3.29	5.49	-91.4	0
150 (3.05x 2.29)	4.12	6.87	-114.3	0
200 (4.06x 3.05)	5.51	9.18	-152.4	0
240 (4.88 x 3.66)	6.62	11.03	-182.9	0
300 (6.10 x 4.57)	8.29	13.79	-228.6	0

The values in the tables are design values and may vary.

**P451W/401W (Aspect ratio 16:10)**

Screen size (m)	Throw distance (m)		Bottom height (cm)	
	Wide	Tele	At Lens Shift 0	At Lens Shift Maximum
30 (0.65x 0.40)	0.83	1.41	-20.2	4.0
40 (0.86x 0.54)	1.12	1.89	-26.9	5.4
60 (1.29x 0.81)	1.71	2.83	-40.4	8.1
80 (1.72x 1.06)	2.29	3.85	-53.8	10.8
100 (2.15x 1.35)	2.89	4.82	-67.3	13.5
120 (2.59x 1.62)	3.47	5.87	-80.8	16.2
150 (3.23x 2.02)	4.35	7.26	-101.0	20.2
200 (4.31x 2.69)	5.82	9.69	-134.6	26.9
240 (5.17 x 3.23)	6.99	11.65	-161.5	32.3
300 (6.46 x 4.04)	8.76	14.58	-201.9	40.4

The values in the tables are design values and may vary.

● **Cabinet Dimensions**

(unit: mm)

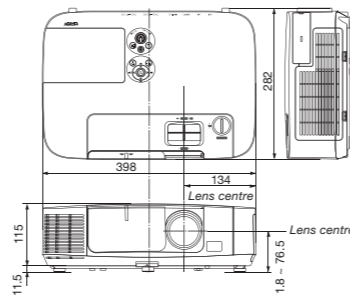

● **Options**

- Replacement lamp: NP23LP
- Cable cover: NP03CV
- Wireless LAN unit\*: NP02LM1, NP02LM2, NP02LM3

\* Please make sure to choose the appropriate wireless LAN unit according to the below list in use country or area.

NP02LM1	United States, Canada, Mexico, Taiwan, Brazil, Colombia
NP02LM2	Europe, United Arab Emirates, Saudi Arabia, Oman, South Africa, Turkey, Ukraine, Egypt, Israel, Australia, New Zealand, Japan, Thailand, China, Hong Kong, Singapore, South Korea, Sri Lanka, Pakistan, Vietnam, India, Indonesia, Philippines, Peru, Chile, Argentina, Ecuador
NP02LM3	Russia

\* In case of used in Malaysia, NP02LM2 has been certified but SIRIM certification sticker should be attached on LAN unit. Please contact your partner in Malaysia before it use.



The projector can be unplugged during its cool down period after it is turned off.  
 Parts of the projector will become heated during operation. Use caution when picking up the projector immediately after it has been operating.  
 Use caution when putting the projector in the soft case immediately after the projector has been operating. The projector cabinet is hot.

● Virtual Remote Tool uses Win2C/DDC library, ©Nicomsoft Ltd.  
 ● HDMI, the HDMI Logo and High-Definition Multimedia Interface are trademarks or registered trademarks of HDMI Licensing LLC.  
 ● Wi-Fi\* is registered trademark of the Wi-Fi Alliance.  
 ● Crestron and Crestron RoomView are trademarks or registered trademarks of Crestron Electronics, Inc.  
 ● Trademark PULink is a trademark applied for trademark rights in Japan, the United States of America and other countries and areas.  
 All other trademarks are the property of their respective owners.  
 The images in this brochure are samples.



Cat.No. WLPJ-1303-312NN

Installation projector

P501X/P451X/P451W/P401W/PE501X

High brightness, high contrast ratio, multi-function projectors, designed for installation in large conference rooms and auditoriums



# High brightness, high contrast ratio, multi-function projectors, designed for installation in large conference rooms and auditoriums



## Features designed to make installation easier

### Keystone correction

This model has two types of keystone corrections. One is built-in Horizontal / Vertical keystone\*1 and pincushion correction\*2.

\*1 Both keystone for Horizontal and Vertical can be used simultaneously.  
\*2 Pincushion function cannot be used with other keystone functions.

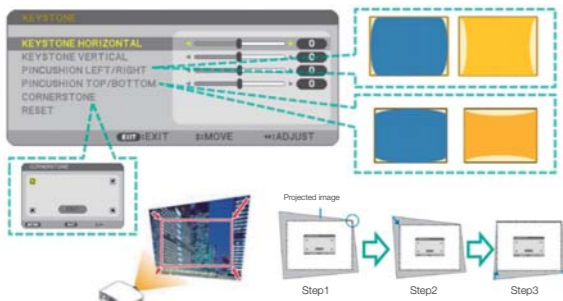

The other is the geometric correction tool (GCT) in the Image Express Utility Lite software that has more functions such as 4 points, multi-points and parameter corrections. Those allow you to correct almost all distortions in the image.

\*Image Express Utility Lite for MAC is not supported.

### Vertical lens shift and 1.7x zoom for flexibility of the installation

The projector is equipped with a lens shift function that can easily move the position of the projected image up or down by rotating a dial left or right, which means that the projector does not have to be moved. The projector also supports a 1.7x zoom to cover a wide throw distance. When combined with the lens shift mechanism, this makes ceiling mountings much easier.

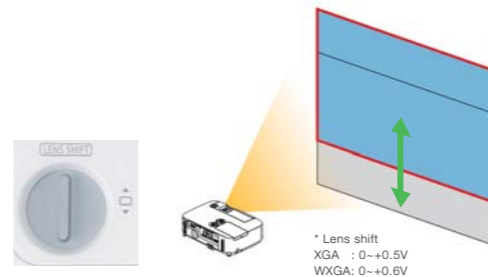

## Advanced functionality designed for wide range of connection and networking

### Streaming video transfer capability ( for Windows)

Image Express Utility Lite allows you to send streaming video from the computer to a single projector over wired or wireless LAN without the need of connecting computer cable.

### Wireless Image Utility (WIU ) for iOS wireless image transmission

WIU can send image from your iOS devices such as iPad®, iPhone® and iPod touch®.

This application has annotation, pointing and magnifying. WIU is available in infrastructure and Ad-hoc connection.



### More network capability

Network capability	Transmission Image	Audio	Streaming Video	USB Display	Geometric correction	Annotation	Pointer	Meeting
Image Express Utility lite for Windows	✓	✓	✓ (Push)	✓	✓			
Image Express Utility lite for Mac	✓							
Wireless Image Utility	✓					✓	✓	
Image Express Utility 2.0	✓						✓	✓

Application software can be downloaded from our web site at [http://www.nec-display.com/dl/en/pj\\_soft/lineup.html](http://www.nec-display.com/dl/en/pj_soft/lineup.html)  
The compatible software is scheduled to be released in the E/Apr.

### Various interfaces

- Two HDMI connectors\*
- Wired /Wireless LAN Port
- USB port for viewer function

#### Computer free presentation

Supported graphic formats	jpg, jpe, jpeg, bmp, png, gif
Supported movie files	mpg, mpeg, wmv, mp4*1
Supported computer files	pdf, ppt, pptx*2, xls, xlsx*2

\*1 Windows media player 11 cannot playback mp4 files.  
\*2 EXCEL and PowerPoint files are available for 97-2007 version only.

### USB Display with audio transfer (Windows only)\*

Using a commercially available USB cable (compatible with USB 2.0 specifications) to connect the computer with the projector allows you to send your computer screen image and audio to the projector.



- Crestron Roomview supported

## Equipped with an abundance of basic functionality

### 16W built-in speaker for an integrated audio solution

Powerful 16W monaural speaker provides volume needed for large rooms. A MIC input is useful for your presentation in a conference room or lecture in a classroom.

\* The MIC input does not support plugin power microphones.



### Equipped with an Auto Eco Mode to automatically control lamp power

Auto Eco Mode automatically adjusts the brightness to suit the ambient light environment. This function can reduce the power consumption by up to 24%. Both the projector and its remote control are equipped with an Eco button for easy selection of Eco Mode.

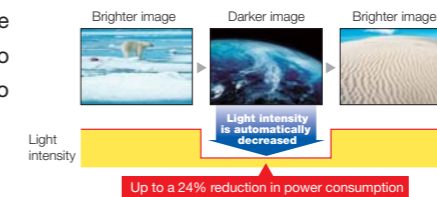

### Equipped with a high performance filter

The large filter has the two-layer construction. It provides excellent dust protection.



### No signal information

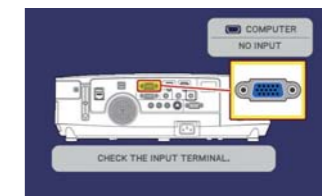

### Lamp life up to 6,000H (Eco mode)

### Contrast ratio 4000:1

### Carbon Meter

### DICOM-SIM. supported

\* Cannot be used for medical diagnosis.

### Quick start, Quick Power Off, Direct Power Off

### Various security functions

- Keyword protection
- Cabinet control panel locks
- Security slot
- Security chain opening

### Terminals

#### P501X/P451X/P451W/P401W

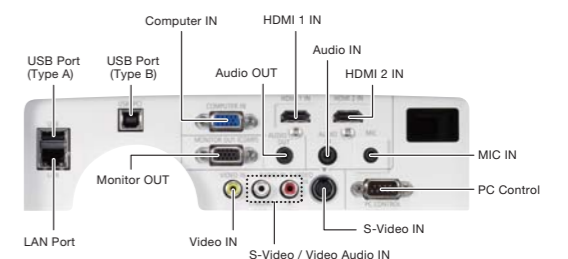

#### PE501X

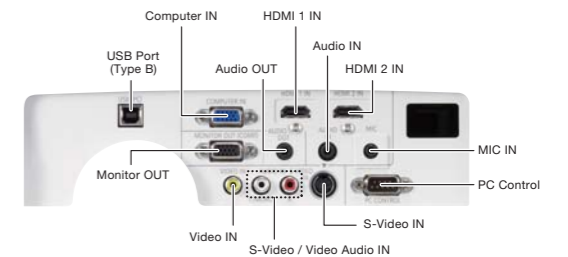

#### P501X

5000 ANSI lumens XGA 4.1 kg

#### P451W

4500 ANSI lumens WXGA 4.1 kg

#### P451X

4500 ANSI lumens XGA 4.1 kg

#### P401W

4000 ANSI lumens WXGA 4.1 kg

#### PE501X

5000 ANSI lumens XGA 4.0 kg

